

OFFICE OF HOUSING AND RESIDENTIAL LIFE
Office of Housing & Residential Life

 The Towers Residential Suites Application 2008-2009
 (Sophomores, Juniors, Seniors and Graduate Students)

Page 1 of 3

Name (Please Print) _____
 Last First Middle Initial

Permanent Address _____
 Number Street Apt. Number

City State Zip Code Country

Phone Number _____ Cell Phone Number _____ Other Phone Number _____

Banner (Student ID Number) _____ Social Security Number _____ WSU E-mail Address (Access ID) _____

Date of Birth _____ Are you over 21? ___ Yes ___ No ___ Male ___ Female

Are you a Wayne State University Athlete? No ___ Yes ___ Please list the sport that you play _____

Undergraduate: Please indicate your **2008-2009**: ___ Sophomore ___ Junior ___ Senior ___ Transfer
 (If you are a transfer student, please list the number of credits you currently have _____)

___ Graduate ___ Law Student ___ Medical Student Applicant's program of study _____

___ DCE ___ TRIO ___ ELI

Are you a returning resident? ___ Yes ___ No Where did you previously live? _____

Do you have any needs requiring special accommodations? ___ Yes ___ No If yes, please specify _____
 (Attach medical documents)

I need housing for (check all that apply) ___ Academic Year (Fall & Winter) ___ Winter, only

International Students Only

Please indicate your country of origin _____

If you are coming from outside of the U.S. please give name, address and telephone number of a contact person in the Metro Detroit area _____

If you need housing information sent to a different address than what you provided above, please include that address on the last page of the application.

Meal Plan Options (Priced Per Semester)

Please note: A choice of 1 of 5 meal plans is required as part of your contract and cannot be changed once the contract is signed.

Type	Description	Cost	Check One
19 Meal Plan (Graduates/Undergraduates)	19 meals a week – Breakfast, lunch & dinner Monday through Friday (during designated serving times). Saturday & Sunday brunch and dinner.***	\$1,200*	
15 Meal Plan (Graduates/Undergraduates)	15 meals a week – Monday through Sunday. \$100 Warrior Dollars each semester.**	\$1,325*	
10 Meal Plan (Graduates/Undergraduates)	10 meals a week – Monday through Sunday. \$50 Warrior Dollars each semester.**	\$1,100*	
5 Meal Plan (Graduates Only)	5 meals a week – Monday through Sunday.	\$600*	
Super 78 Block (Graduates Only)	Any 78 meals a semester for self or guests.	\$500*	

*These figures reflect the current 2007-2008 rates only and not the 2008-2009 rates and are therefore subject to be increased for the 2008-2009 school year. **Meals may be taken during any of the meal periods offered. *** Missed meals cannot be made up during another meal period.



OFFICE OF HOUSING AND RESIDENTIAL LIFE

The Towers Residence Hall
Room Options (Priced Per Academic Year)



A. Four Person Suite:
Two, double occupancy bedrooms
\$4,408 per person



B. Four Person Suite:
Two, double occupancy bedrooms and shared living space
\$4,902 per person



C. Four Person Suite:
(Limited number available!) Two, single occupancy bedrooms, one shared bedroom and shared living space
Single room: \$5,192 per person
Double room: \$4,671 per person



D. Four Person Suite:
Four, single occupancy bedrooms and shared living space
\$5,192 per person



E. One Bedroom:
(Limited number available!)
One, single occupancy bedroom
\$6,132 per person

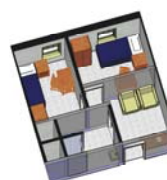

F. Two Person Suite:
Two, single occupancy bedrooms with small living area.
\$5,448 per person



G. Two Person Room:
One, double occupancy bedroom
\$4,302 per person

Rank In Order of Preference 1= first choice	
Suite A	
Suite B	
Suite C	Single
Suite C	Double
Suite D	
Suite E	
Suite F	
Suite G	

Room Information:
Please have the student complete this section

Resident Profile: This information will be kept confidential and is used by the WSU Office of Housing & Residential Life to determine your optimum room assignment.

Do you smoke? ___ Yes ___ No

Do you object to smoking ___ Yes ___ No

Please note: WSU residence halls are smoke-free facilities. We do, however, recognize students will smoke outside.

What would you consider yourself as? ___ An early riser, before 10:00 a.m. ___ A late riser, after 10:00 a.m.

Is your usual bedtime: ___ 8:00 p.m. to midnight ___ After midnight

As a housekeeper, how do you see yourself? ___ Neat ___ Messy

How do you picture your room atmosphere? ___ Social ___ Study

Please list your preferred roommate's name (s) and WSU ID Number(s) _____

(In order to be placed with your preferred roommate(s), he/she must also indicate your name and WSU student ID number)

Roommate preferences must be received by June 29, 2008.

